

PRO-ECO-LITE™ DESIGN INFORMATION

PRO-ECO-LITE™ HEADWALLS

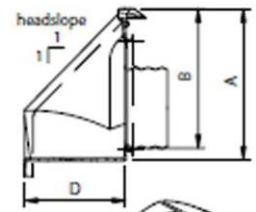

Standard Headwall 45 Degree Head Slope

Series	Max. Pipe Dia (mm)	A (mm)	B (mm)	C (mm)	G (mm)	Max. Gate Dia (mm)	Weight of Headwall and XPORT (Pipe weight not included) (kg)
1.5	300	444	394	330	725		39
2	375	600	508	355	1090	305	60
3	600	920	650	650	1340	457	165
4	900	1300	915	915	1905	762	295
5	1200	1600	1550	1170	2360	914	748



Aprons are available for high erosion wash-out conditions.

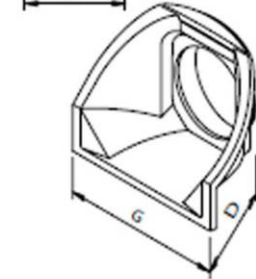

Low-Profile Headwall 22.5 Degree Head Slope

Series	Max. Pipe Dia (mm)	A (mm)	B (mm)	C (mm)	G (mm)	Max. Gate Dia (mm)	Weight of Headwall and XPORT (Pipe weight not included) (kg)
2	375	600	585	450	895	305	60
3	600	910	825	675	1345	457	165
4	900	1275	1180	975	1905	762	295
5	1200	1615	1430	1200	2380	914	748
6	1600	2140	1890	1615	3150	1067	1204
7	2200	2620	2320	1952	3850	1219	1850



Trash gates and security grids for extra protection of your headwall inlet/outlet.

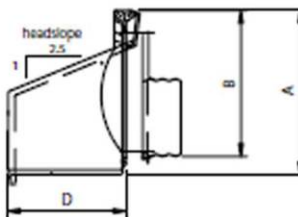
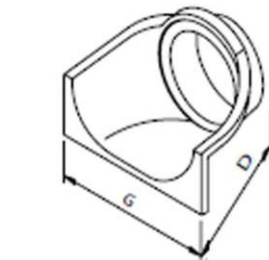

*Invert dimensions "B" for flap and sluice gate models may vary.



Factory Installed Flow Control Options



Sluice Gates/Tideflex Valves.



Flap Gates.



Wier Boards.



CIF Composites Inc.
 1810 Verling Avenue, Saanichton, BC V8M 1X6
 T: 250.652.6313 F: 250.652.4800
 Email: info@cifcomposites.com
 Website: www.cifcomposites.com

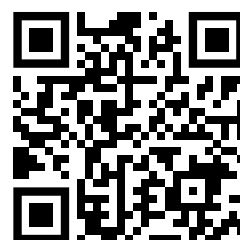

CIF COMPOSITES INC.

*Lightweight, Engineered
 Inlet and Outlet
 Control Structures*

PRO-ECO-LITE™ Headwalls

Engineered from a composite reinforced polymer concrete, CIF PRO-ECO-LITE™ Headwalls combine the lightweight characteristics of plastics, with the strength of concrete.

Benefits of our CIF PRO-ECO-LITE™ Headwalls include:

- **Lightweight** - typically 10% of the weight of conventional concrete headwalls. Ideal for weak subgrade conditions.
- **Fast and Simple Installation** - less manpower and lighter machinery to ship, handle and install. Easily maneuvered by hand or on-site equipment.
- **Durability** - composite reinforced polymer concrete is designed to meet the most demanding applications - chemical resistant, UV stabilized and non-corrosive.
- **Versatile Connection** - ENVIRO-CONNECT™ and XPORT™ systems provide a simple, positive (no grout) connection to all pipe types and sizes from 100mm to 2200mm. Concrete pipe connections are made possible with a fibreglass spigot or belled end.
- **Environmental Benefit** - fish friendly, non-leaching, non-corrosive materials, meeting Federal requirements for non-polluting of streams and ditches.



Unique design allows quick and simple installations.

PRO-ECO-LITE™ design is protected under Canadian and U.S. laws. Patent numbers D477,544 and D77,543.



How our X-Port™ works for simple field connections.



Headwalls can be installed to any pipe type from CSP, HDPE and even concrete !

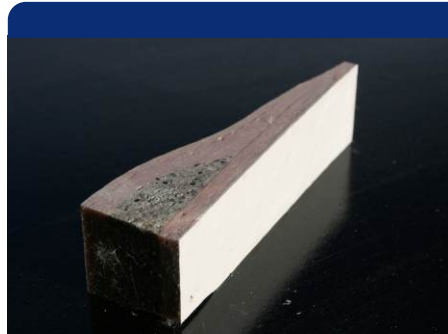

Typical PRO-ECO-LITE™ polymer concrete composite cross section.

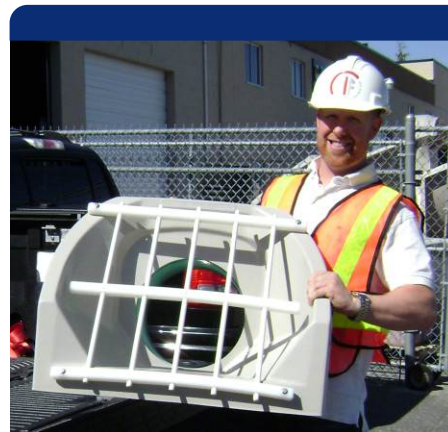

Your lightweight alternative.

FOUR EASY STEPS



Working with the customer we can aid in choosing the correct model and accessories, to suit your needs.

1



The completed product can be palletted and shipped directly to you jobsite for installation.

2



Upon arrival to the jobsite, lightweight machinery can upload and lower the headwalls into place.

3



Once lowered into place and connected to the existing pipe, the structure can be backfilled. The complete installation can be finished with a variety of end treatments, including rip-rap slope protection, sod/grass, or cobbles, as shown.

4



Ideal for driveway and ditch crossings.